

● drawing
UNIT C - FIRST FLOOR PLAN
 - all work to be done in accordance with the code (ASD)
 - figured dimensions to be taken in preference to scaled dimensions
 - report any discrepancies direct to the architect before commencing work
 - this drawing is copyright and remains with the architect



● project **PROPOSED NEW WAREHOUSE**
 ● location **PTN 84 RIVERHORSE VALLEY**
 ● client **EXTREME ENTERPRISES**



● scale **1:200**
 ● date **03 OCT. 2006**
 ● drawn **PC**

● drawing no **05080wg106**

● revision
A

101 123 4 575 8000
 102 123 4 575 8000
 103 123 4 575 8000
 104 123 4 575 8000
 105 123 4 575 8000
 106 123 4 575 8000
 107 123 4 575 8000
 108 123 4 575 8000
 109 123 4 575 8000
 110 123 4 575 8000

SCHEDULE OF AREAS	
UNIT C	
ground floor area	72 sqm
mezzanine	223 sqm
warehouse	563 sqm
first floor area	148 sqm
total floor area	1 008 sqm

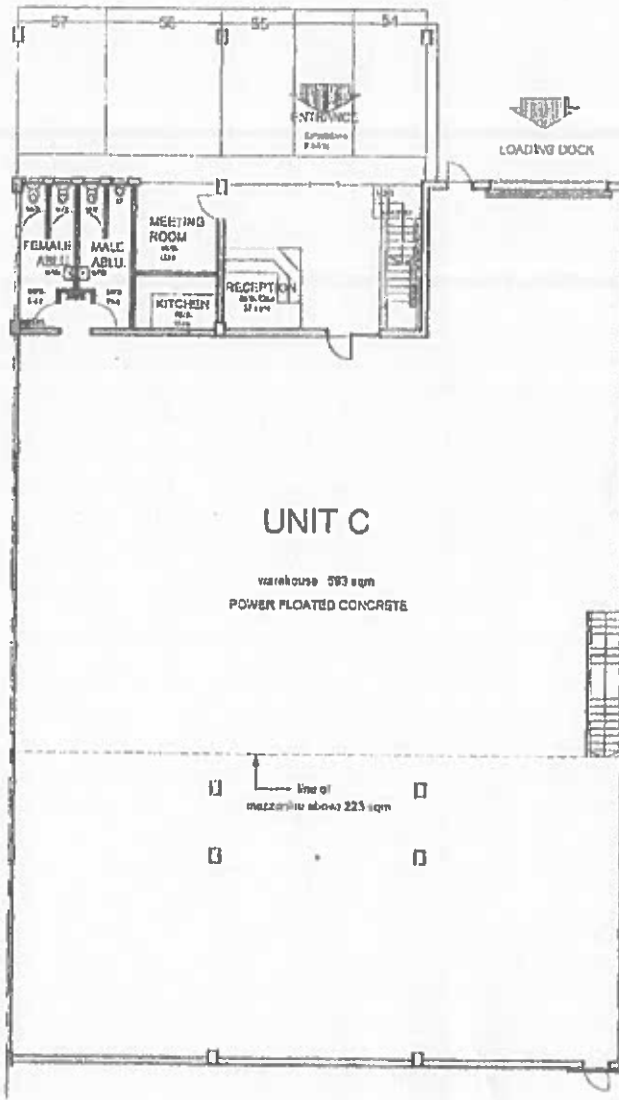

● drawing
UNIT C - GROUND FLOOR PLAN
 all work to be done in accordance with the rules (ACI)
 figured dimensions to be taken in preference to scaled dimensions
 report any discrepancies direct to the architect before commencing work
 this drawing is copyright and remains with the architect.



● project **PROPOSED NEW WAREHOUSE**
 ● location **PTN 84 RIVERHORSE VALLEY**
 ● client **EXTREME ENTERPRISES**



● scale **1:200**
 ● date **03 OCT. 2006**
 ● drawn **PC**

● drawing no **05080wg105**

● revision
A

P01 02 21 526 BRND
 P02 02 21 526 BRND
 P03 02 21 526 BRND
 P04 02 21 526 BRND
 P05 02 21 526 BRND
 P06 02 21 526 BRND
 P07 02 21 526 BRND
 P08 02 21 526 BRND
 P09 02 21 526 BRND
 P10 02 21 526 BRND

Handwritten notes and signatures at the bottom of the page, including 'APC' and other illegible text.